

Key Plan



Connectivity

- Domestic Airport : 5 Km
- Railway Station : 10 Km
- Near Petrol Pump : 0.3 Km
- Commercial Hub : 0.2 Km

<p>DEVELOPERS S.S. Corporation</p>  <p>Manav Group Bapu Developers</p>	<p>ARCHITECT</p>  <p>Blacklink™ Sanjay Josshi</p>	<p>STRUCTURE DESIGNER</p>  <p>Bhagat Associate Surat.</p>	<p>SITE ADD.</p> <p><i>Umiya Bungalow</i></p> <p>T.P. 37 FP. 41, Near Shri Khatu Shyam Baba Temple, Althan V.I.P Road, Surat.</p>
--	--	---	---

NOTES

- 1) Stamp Duty, Registration charges, Legal charges, GEB & SMC charges & taxes, Society maintenance charges & Safety grills expense etc. shall be borne by the purchaser. VAT, SERVICE TAX etc. will borne by the purchaser.
- 2) Any additional charges or duties levied by the government / local authorities during or after the completion of the scheme like SMC tax, betterment charges will be borne by the purchaser.
- 3) In the interest of continual developments in design & quality of construction, the developer reserve all rights to make any changes in the scheme including technical specification, designs planning, Layout & all purchasers shall abide by such change.
- 4) Uniform designed of windows Grill extra expanse to be born by owner.
- 5) Any type of External changes strictly NOT ALLOWED during or after the completion of the scheme. Internal changes will be done only with prior approval & will be charged extra with total responsibility of purchaser.
- 6) This brochure is intended only for easy display & information of the scheme & does not form part of the legal document.
- 7) The floor area and dimension mentions are approximate and shall veri as per the approval and standard site variance.



S.R. DESIGN 98253 66393

High life with Future...





Welcome to a truly green innovation...!

Welcome to the world of peace and prosperity. This residential project makes you live in perfect harmony with nature. Umiya Bungalow has been specially designed to provide ultimate comfort, secure & healthy living in the nature's own lap.

We are sure your quest for ideal home will end here at Umiya Bungalow.



Mark of excellence

A virtue of thoughtful creation

Umiya Bungalow is created with deep thoughtfulness, ultra modern design sense and meticulous craftsmanship. Therefore it takes care of not only the staple needs of the inmates but also provides for emerging lifestyle needs.





Peace of Mind



Immersed in nature and it's perpetual beauty!
The comforts that one gets at home cannot be compared to any other place in the world. It is nature in it's pristine form which provides health, happiness and peace of mind to the stressed souls.



Umija Bungalow



Layout Plan

A community of elegant, with the best of design to fulfill your every need and make your dream come true.

- Entry
- Security cabin
- Plantation Bed
- Floral Garden
- Green Space
- Cluster Seating
- Party Lawn
- Children Play Area
- Jogging Track
- Exit



Ground Floor

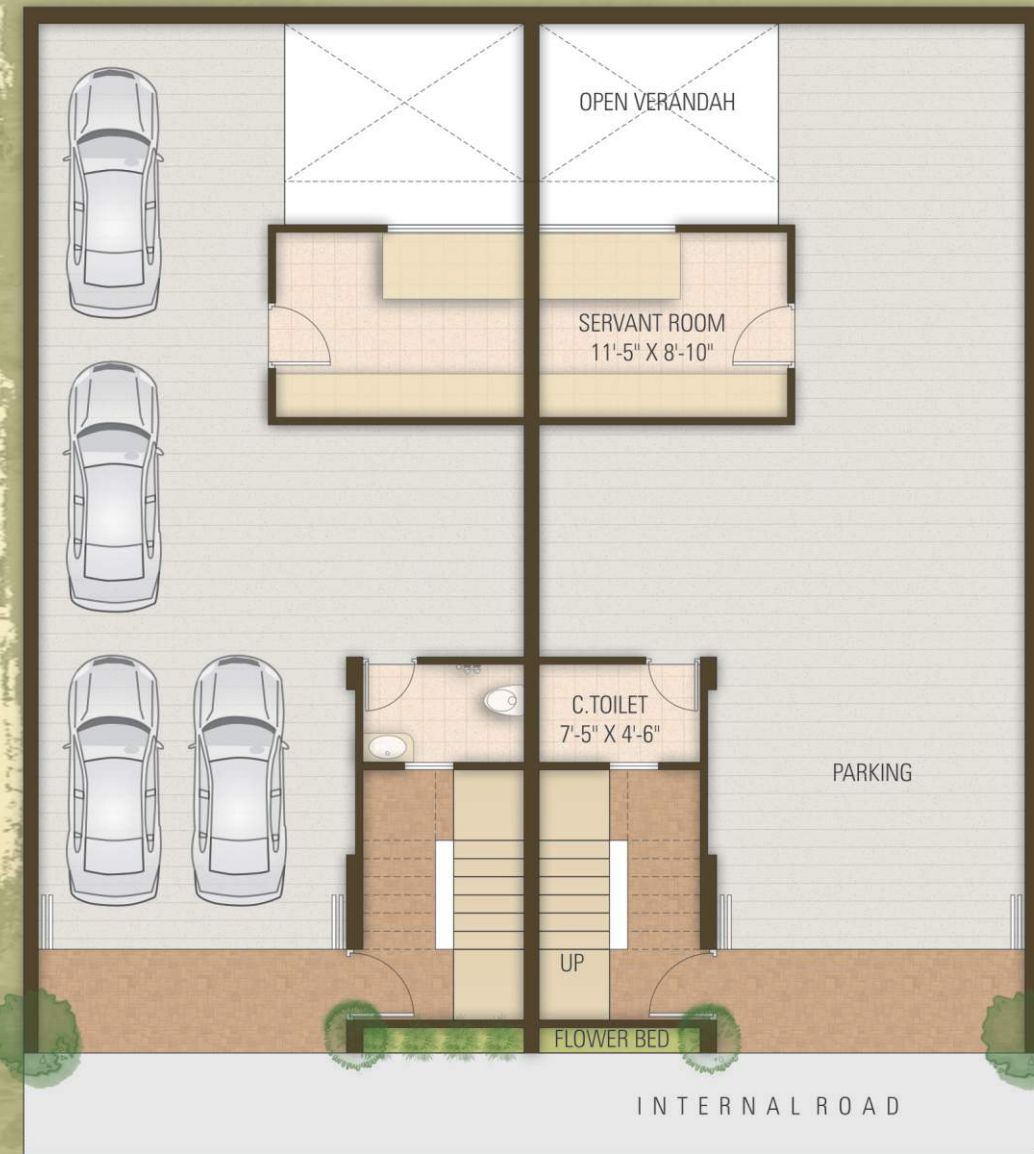

Uper Ground Floor



First Floor



Second Floor





Inter weave nature in to your life

Umiya Bungalow an ideal avenue for perfect and peaceful lifestyle homes will coddle you with very same amenities for the rest of your life everyday!





*Sign of thoughtfulness,
A home of contemporary lifestyle*

Umiya Bungalow is a well thought, well planned and well laid residential project that provides complete range of modern urban lifestyle features to meet every need of the urban elite who seeks best of life and lifestyle for his family.





Special Features

- Gorgeous main gate with C.C.T.V Camera & decorative compound wall.
- Common office for society maintenance in COP area.
- Earth quake proof R.C.C. Structure.
- Internal trimix concrete & paver block road with street light.
- Common generator for society street light & COP area, common boring in COP.
- Over head & underground R.C.C. water tank in each units.
- On terrace floor glazed ceramic tiles with water proofing.
- M.S. fabricated railing at backside varanda.
- Well designed landscape garden in COP.

Specifications

Flooring

- Glazed ceramic tiles in parking.
- Italian tiles in living & kitchen area.
- Superior quality vitrified (2'x2') tiles in all rooms.
- Kota stone in wash
- Granite steps with S.S. Railing on all stapes

Kitchen

- Black granite top platform with S.S. sink & decorative wall tiles dedo over kitchen platform.

Toilet & Bathrooms

- Standard quality sanitary wares & C.P brass fitting decorative glazed dedo upto full hight with moden concept ceramic tiles in flooring.
- Central geezer point in each unit.

Door & Windows

- Attractive main door in sal wood frame good quality flash door.
- Granamite Frame in toilet & bathrooms.
- Granite windows seal and anodize aluminum section window with mesquites net.

Electrification

- Sufficent point with concealed wiring with standard accessories T.V. point in living room & bed room A.C. point in bedrooms.

Plumbing

- Concealed plumbing work with good quality pipes of standard company.

Paint

- Birla putty over internal wall and apex paint over external wall.